

**⚠ IMPORTANT.**

Read this notice before placing the DRINKING TUBE KIT on your helmet!

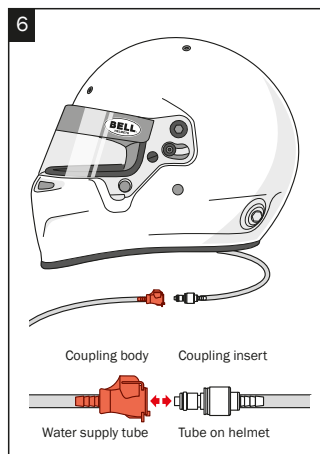
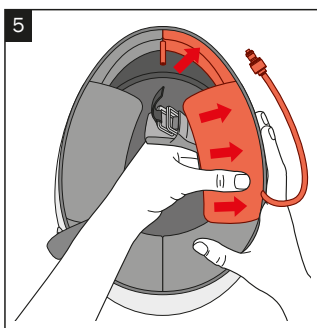
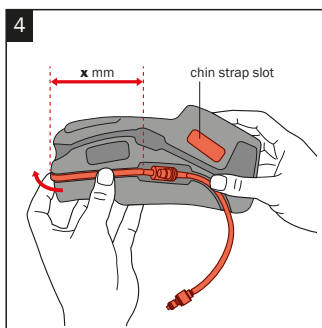
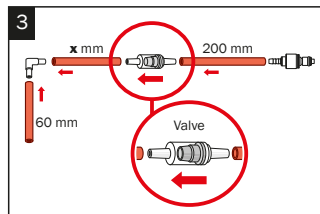
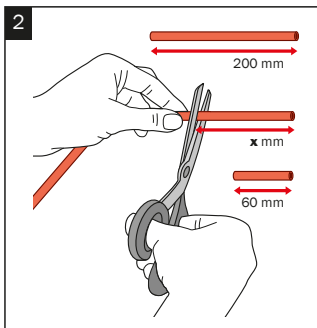
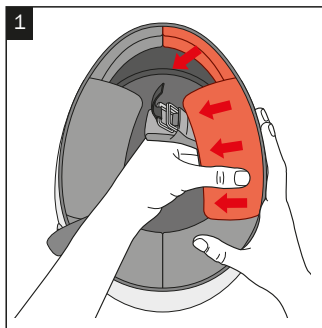

1. Remove 1 cheek-pad/face piece assembly (left or right). Recommending to install on the drivers left side of the helmet as illustrated.
2. Cut the supplied drinking tube in 3 pieces: 1 of 60 mm length, 1 of 200 mm length, and the other one cut after measuring the "length" of the channel. (from the edge of the recess for the valve to the water line opening in the front of the face piece) marked in figure 4 to have the correct **X** mm length.  
**Note:** Please cut 10 mm more to the measured length for tolerance.
3. Connect all pieces together in the following order: 60 mm drinking tube, elbow connection, **X** mm drinking tube, valve (make sure the arrow is pointed to the **X** mm tube), 200 mm drinking tube and Coupling insert.
4. Place the drinking tube in the channel on the lower part of the cheek-pad/face piece assembly.
5. Place the cheek-pad back to its original position by Passing the chin strap webbing through the **chin strap slot** (illustration 4) on the cheek-pad. Make sure to Place the front of the cheek-pad in the designated area against at the center of the shell. Then pull the webbing out and push the face piece against the shell and make sure its installed properly in the correct position.
6. Attach the coupling insert on the helmet water supply line to the hydration system installed in the car.

**NOTE**

The drink tube kit is designed for Bell Racing full face helmets that have a recess in the face piece to accommodate the valve and water line. Some entry level models do not have this feature.

If you have questions regarding the installation instructions or you need additional assistance with reinstalling the cheek pad/face piece assembly, please refer to the Bell Racing website to contact one of our representatives.