

! IMPORTANT.

Read this notice before placing the FLAT SIDE COVER on your helmet!

The HP10 Rally, Mag-10 Rally Carbon and Mag-10 Rally Pro are delivered with a side cover integrating the Nexus female radio connector.

For those wanting the radio connector hanging on a loose cable, the connector side cover can easily be replaced with this flat cover.

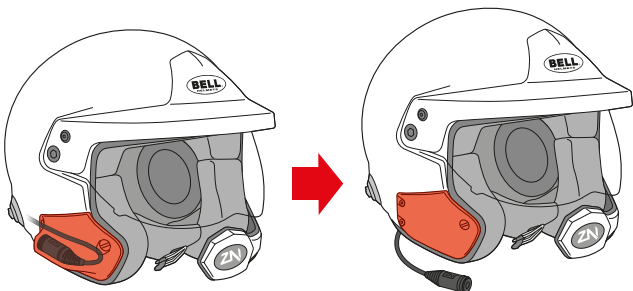

DIRECTIONS TO REPLACE Integrated side cover with Flat side cover

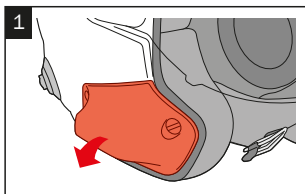

1. Unscrew and remove the side cover that integrates the Nexus radio connector. Use the hexagonal wrench included in the kit for the hex screws, and a bell wrench or flat screwdriver for the flat screw.

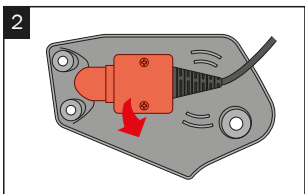

2. Unscrew and remove the bracket containing the Nexus connector from the side cover.

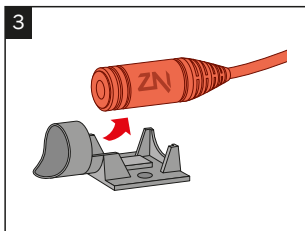

3. Unclip the Nexus radio connector from the bracket

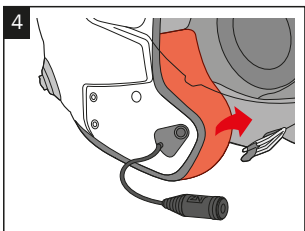

4. Disassemble the inner cheek padding of the Helmet by gently pulling it off (it is attached to helmet by Velcro).

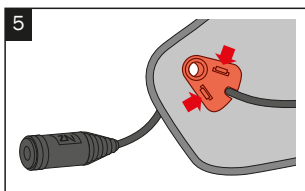

5. Disassemble the triangular piece that holds the cable. Press the two tabs that appear on the inside and separate the two pieces.

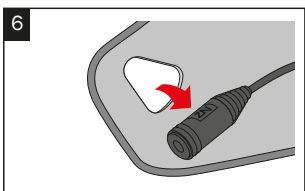

6. Pass the Nexus radio connector through the triangular hole that was left free towards the inside of the helmet and position it on the inner side of the shell, near the edge of the liner.

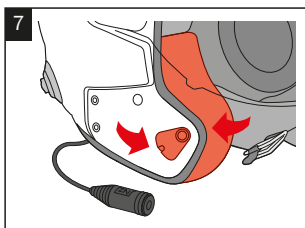

7. Assemble the triangular piece and the Inner cheek padding back in their original position.

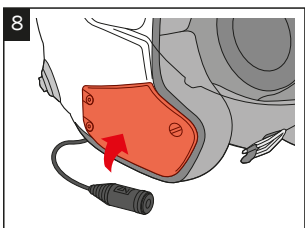

8. Install and screw the new flat side cover.